

P B



PBOX[®] X3

Bluetooth/Bluetooth Speaker Version

User Manual

Thank you for choosing LEADSUN PBOX X3 Integrated Solar Light.

If you have any question, please consult our customer service sales@leadsunglobal.com.

LEADSUN (International) Ltd. reserves the rights to amend and improve the product appearance, function and construction without any prior notification.

Please make the object as standard in case of any difference in description.

LEADSUN guarantees that the User Manual has been approved well, but won't bear the responsibility for any loss.

Contents

Product Maintenance & Disposal	2
1.1 Cautions	2
1.2 Disposal	3
User Manual	4
2.1 Instructions	4
2.2 Technical Data	5
2.3 Packing List	6
2.4 Installation Instructions	8
2.5 APP Operation Illustration	13
Trouble-shooting	15

1. Product Maintenance & Disposal

1.1 CAUTIONS:

Please carefully read the following directions when you use the PBOX X3 integrated solar light in order to avoid damage or malfunction.



· **Children are forbidden to climb or play with the lamp post for safety reasons.**

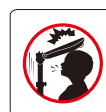

· **Be careful of lamp head falling down suddenly when you pull extendable pole out as well as push it back.**



· **For products installed with water base, please push pole back or bring the products back indoors during storms or strong wind (31mile/h or above), so as to avoid unexpected damage to the products or hurt pedestrians.**

- Do not drop this product or drop any item thereon.
- Do not immerse this product in the water.
- Do not use any detergent that contains ammonia, benzene or abrasives to avoid any damage to the product .
- Only use software provided by LEADSUN so to avoid malfunction.
- For long-term storage, batteries need to be recharged every 3 month to maintain battery life.
- When installing, keep away from the shadow of trees, building and etc., so as to avoid the damage to the solar panel.
- For high performance, regularly apply the neutral detergent with a damp cloth and gently clean the surface of the solar panel.

Operating and Storage Temperature

The discharge temperature ranges from -4°F to 140°F (-20°C - 60°C).

Recharge at a temperature between 32°F to 140°F (0°C - 60°C).

The controller will automatically stop charging in order to protect the battery if the temperature drops below 32°F (0°C) or rises above 140°F (60°C).

Please ensure not to install this products in the area where the extreme temperature conditions exceed its limits.

In cold areas, please select the products equipped with heating system. However, the operating hour shortens due to the cold weather.

Store the products at a temperature between 32°F to 95°F (0°C-35°C)

Modification:

It is not on the term of warranty if client does modify & refit the light leading to non-proper working without authorization of LEADSUN.

Replacement of Parts / Spare Parts:

If you need information or if you have a problem, please visit the LEADSUN website at www.leadsunglobal.com or contact your local distributor / dealer.

1.2 Disposal:

Our product is made of recyclable high-performance materials and components. Do not throw away the appliances with the normal household waste at the end of their life, but hand them in at an official collection point for recycling. By doing this, you help to preserve the environment.

Please refer to local laws & regulations involved in classified collection of electrical products and electrons. Properly-disposing of the wastes can helpfully avoid potential negative influence to environment and human health.



2. User Manual

2.1 Introduction

With elegant and smooth design, PBOX X3 Smart Solar Lamp provides brightness over 400lm. You can easily control the brightness, work mode and operation of the lamp via APP on your smart phone. The special designed telescoping lamp pole unit is not only easy to install, but also bring you so much convenience and fun.

PBOX X3 Bluetooth speaker even surprises your experience with enhanced dual stereo.

PBOX X3 invites you to enter into a new everyday life of efficiency, convenience and delight.

PBOX X3 Functions:

1. Three operating modes: automatic On and OFF, customized and manual control via APP on your cellphone.
2. Recharged by solar panels, or via Micro USB port (USB cable and AC/DC adaptor not included).
3. High-performance lithium battery can sustains 14+ operating hours for the LED lamp, or 20+ hours for the Bluetooth speaker.
4. Recharge mobile phones, tablets and other potable electronic devices.
5. Customize operating mode according to local weather.
6. Look up charging current and historical charging and discharging data.
7. Play music (PX3BL only).

Caution: Items 5, 6 and 7 are applicable via LIVESUN APP. LIVESUN APP is compatible with Android 4.0 and above, and iPhone 4s, iPad 2, iPad mini and above.



2.2 Technical Data

Model No.		PX3B	PX3BL
Physical Specification			
Solar Panel		12W/9V	12W/9V
IP Rate		IP65	IP65
Lithium Battery		58 Wh	58 Wh
Power of Speaker		N/A	12W
Charging Output		5V 2A max	5V 2A max
Heating Function		Optional	Optional
Net Weight		6.8lb (3.1 kg)	7.9lb (3.6 kg)
Body Size		476×276×86 mm	476×276×86 mm
3m Lamppost		Optional	Optional
Charging / Discharging Time			
Discharging Time		Full bright: ≥14hours	14+ hours for LED or 20+ hours for speaker
Charging Time	Charged by Solar panel ⁽¹⁾	6hrs	6hrs
	Charged by Micro USB ⁽²⁾	12hrs	12hrs
Light Output			
Luminous Flux		>400 lm	>400 lm
LED		Samsung	Samsung
Visual Angle		120°	120°
Color Temperature		4000k	4000k
Environment Rating			
Working Temp.	Charge Temp.	32 F to 140 F (0°C~+60°C)	32 F to 140 F (0°C~+60°C)
	Discharge Temp.	-4 F to 140 F (-20°C~+60°C)	-4 F to 140 F (-20°C~+60°C)
Battery Storage Temp.		-4 F to 113 F (-20°C~+45°C)	-4 F to 113 F (-20°C~+45°C)
Package			
Main Body G.W.		8.4lb (3.8 kg)	9.5lb (4.3 kg)
PBOX X3 Suite G.W.		20.9lb (9.5 kg)	22.0lb (10 kg)
Box Size of PBOX X3		480×320×140 mm	480×320×140 mm
Box Size of PBOX X3 Suite		920×385×215 mm	920×385×215 mm
Instructions			
Recommended Installation Height Range		3-4m	3-4m
Recommended Installation Distance of Poles Range		8-10m	8-10m

(1). Working time data as above are based on 8 hours of charging in good sunny days in summer, measured at the latitude 22°, east longitude 113°. Actual working time might be different according to difference of area, season, environment and direction.

(2). USB charger output: 5V 1A

2.3 Packing list

Please confirm that you have received goods as follows (Item #3 #4 #5 #6 #7 are components for the lamppost which need to purchase separately.):

1. Main body
2. Back Stand
3. Lamppost
4. Base Pin
5. Lamppost Kit Bracket
6. Water Base
7. Screws of 3pcs ST3×4mm and 3pcs ST4×10mm
8. Anti-theft Spanner
9. User Manual

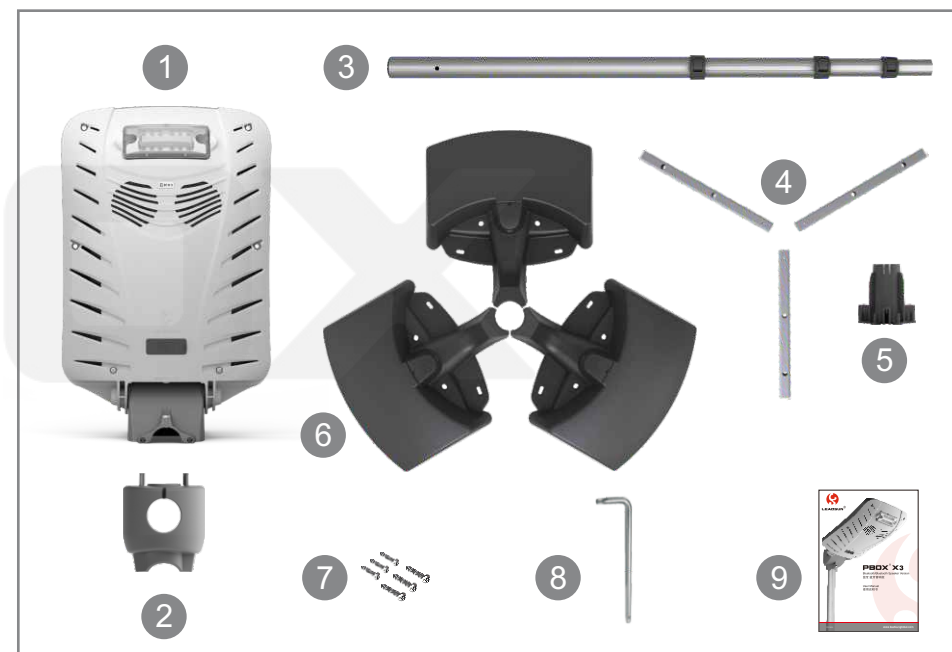

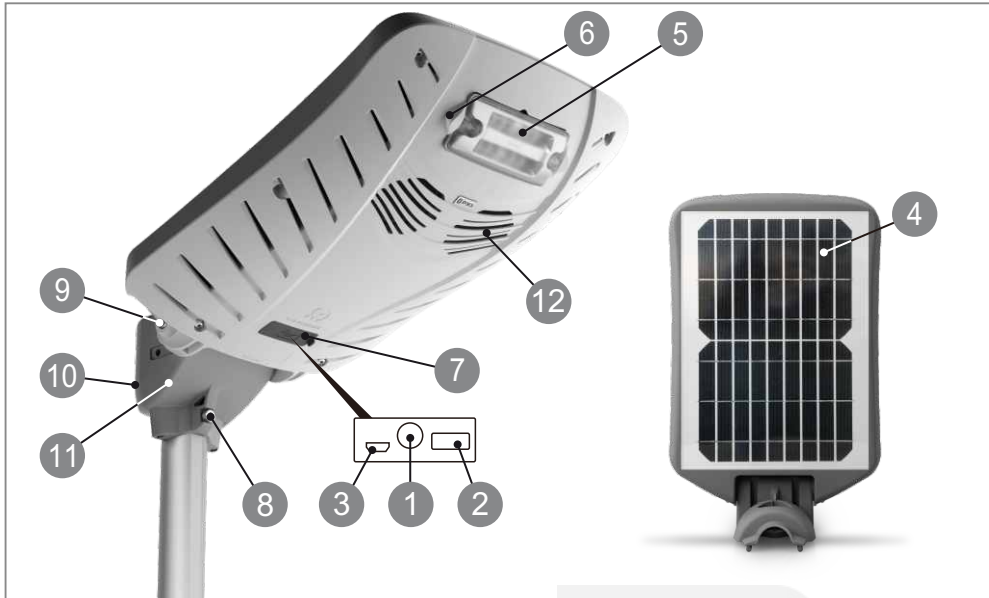

No.	Name	Brief of Function
1	Switch	Turn ON/OFF the PBOX X3 system
2	USB	Charge for external devices
3	Micro USB	Charge for PBOX X3 (PX3S model without micro USB)
4	Solar Panel	Charge for PBOX X3
5	LED Module	Illuminate
6	M4×15 Screw	Fix LED module
7	Rubber Lid	For waterproof purpose
8	M6×50 Screw	Fix PBOX X3 onto the lamppost
9	M6×30 Screw	Adjust angle of LED module
10	Back Stand	Use jointly with lamp frame
11	Lamp Frame	Prop main body
12	Water-proof Speaker (PX3BL only)	Playing music

2.4 Installation Guide

Open the package and take the PBOX X3 out.

Open the Rubber Lid at the bottom and press Power Switch (switch 1, as shown in the picture on the left). Put the rubber lid back on after that so the product stays waterproof. Light should be on if you cover the solar panel at this time.



Type A: Wall-mount the Lamp

Use a $\Phi 8$ drill bit and make two holes on the wall. Put two M6 expansion bolts into the holes. Place the lamp on the wall by fastening the expansion bolts with a hex screwdriver (as seen in the picture on the left).

Tips: For the best performance of the solar panel, try to fix the lamp as close to the top of the wall as possible when installing.

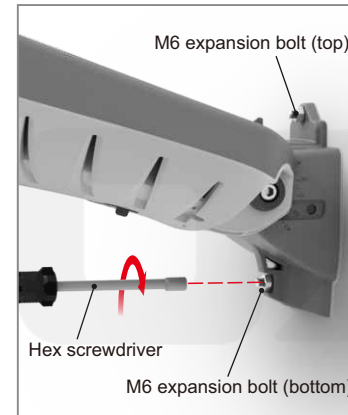

Type B: Stand the Lamp on the Ground

Insert the back stand into the lamp frame to stabilize the lamp (as shown in the picture on the left).



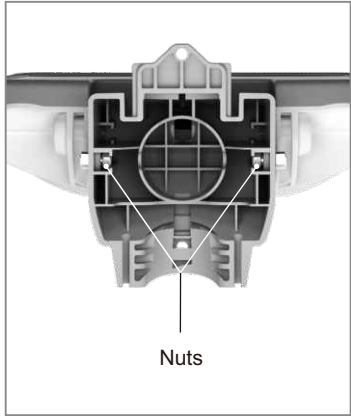

Type C: Install Lamp on an Arm Pole

C1. Find two holes on both sides of the frame. Place two nuts individually into the slots. Insert the screws through the holes and secure the nuts (as shown in the picture on the left).

Caution:

The diameter of the Arm Pole is required to be 30~40mm, If beyond the diameter, please buy a special converter port to install the lights.

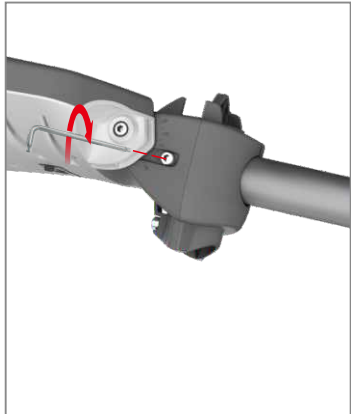

C2. Inset the lamp base in the frame, and then insert the arm pole into the lamp frame. Fasten the screws with the Anti-theft Spanner (as shown in the picture on the left).

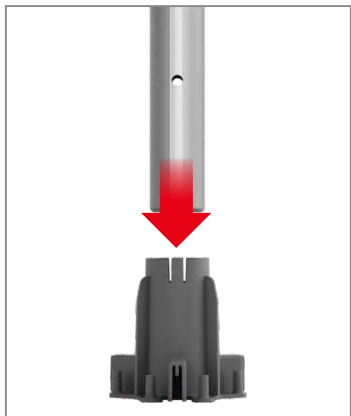

Type D: Install with LEADSUN Optional Lamp Post.

D1. Insert the lamp pole into the bracket. Make sure to match the holes on the lamp pole with the snap joints on the base.

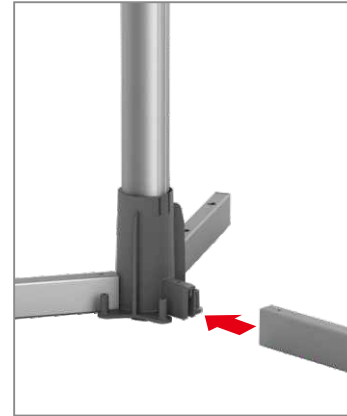

D2. Joint the three pins with the correct position of bracket, and fix the pins by ST4 × 10mm (as shown by left diagram)



D3. Fill the Water Base with water.

Place three Water Base unto the base pins to stabilize the lamp post (as shown in the picture on the left).

Caution:

1. Fill the water base with cold water or sand as per demand.
2. Add one spoon of Chlorine Bleach with cold water to prevent the algae.
3. Make sure the cover is sealed well avoiding any leaking.
4. The three Water Base must be used together, once one is leaking, please stop using and contact seller for replacement.

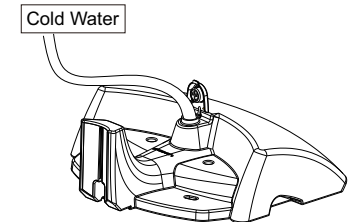



D4. Place the lamp onto the pole.

Match the hole on the lamp with the hole on the pole, and insert the screw in.

Fasten the screw and secure the lamp on the pole (as shown in the picture on the left).

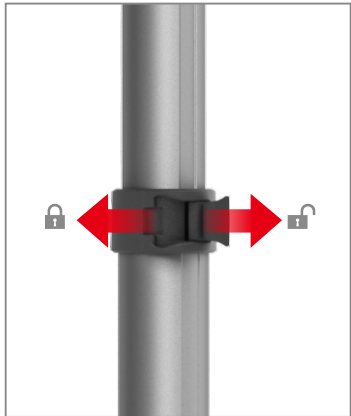

D5. Fix the pole.

Pull the extendable pole out and then fasten the tightener from top to bottom (as shown in the picture on the left).

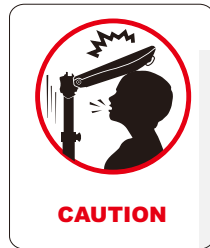

Be careful when pulling extendable pole out as well as pushing it back into place.

CAUTION

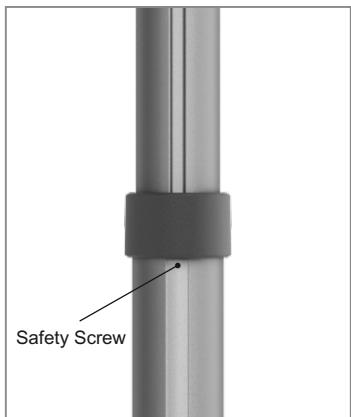

D6. To prevent any accident caused by a loose tightener, please lock a ST3 × 4mm safety screw under the bottom section of the pole. (As shown by left diagram)



Children are forbidden to play with the lamp post.

CAUTION

E. Angle Adjustment illustration:

E1. Solar panel angle adjustment: loosen two M6 screws on both sides of main body, and adjust it to suitable position and lock screws.

E2. LED module angle adjustment: turn the LED module to suitable position with your finger. (Refer to the below figure)



Caution: To avoid the damage or personal injury, you must hold the lamp body against suddenly dropping down when you loosen the screws to adjust the angle of solar panel.

2.5 APP Operation Illustration

To control PBOX X3, you should install our well designed software "LIVESUN APP" on your phone as below step A or B.

A. Iphone: please scan QR code below or search "LIVESUN" in "APP Store", and then click to install.

B. Andriod Phone: please scan below QR code or login www.leadsglobal.com, Google APP or related software platform, and then download LIVESUN APP and install.



LIVESUN APP
for Apple



LIVESUN APP
for Andriod

You can do the below through APP:

1. Register a member.
2. Control the light.
3. Inquire historical data.
4. Set working mode.
5. Real-time supervision.
6. Music playing (PX3BL only).
7. Micophone (PX3BL only).

For further details, please kindly check 'Use Guide' under 'other functions' in the APP.

3. Troubleshooting

No.	Problems	Checking steps	Solutions
1	The light wouldn't turn on.	Check if the power switch is ON.	Turn on the power switch.
		Check if the solar panel is shaded.	Remove the items covered the solar panel, or relocate the lamp to an unshaded position.
		Check if the solar panel is under a strong light source.	Remove the light sources ,or relocate the lamp to avoid the light source.
		Check the APP on your phone, and see if the power button is OFF.	Press the power button to turn on the light.
2	Extremely short operating time at night.	Use the real-time self-checking on your APP for troubleshooting.	Contact the manufacturer for maintenance after troubleshooting.
		Check if the lamp is under any shade caused by trees, buildings and etc.	Remove the items covered the solar panel, or relocate the lamp to an unshaded position.
		Check if the solar panel is covered with dust or other items.	Clean the surface of the solar panel, or remove the items covered the solar panel.
		Check if the operating mode set on your APP is correct.	Reset the working mode to reduce the lamp power or operating time .
		Use the real-time self-checking on your APP for troubleshooting.	Contact the manufacturer for maintenance after troubleshooting.

No.	Problems	Checking steps	Solutions
3	Would't charge mobile devices.	Check if the USB charging cable is broken.	Replace the USB charging cable.
		Use the APP to check the power level of the battery.	Recharge the PBOX X3 if the power level of the battery is low.
		Use the real-time self-checking on your APP for trouble-shooting.	Contact the manufacturer for maintenance after troubleshooting.
4	Bluetooth connection failed.	Check if your phone has installed the LIVESUN APP.	Install the LIVESUN APP.
		Check if the power switch (switch 1) is ON.	Turn on the power switch (switch 1).
		Restart the lamp.	Press the power switch (switch 1) to turn off the lamp. Wait for 10s to restart the lamp.
		Check if it is out of battery.	Recharge the PBOX X3.
5	Music playing function is failed. (PX3BL only)	Check if your phone has installed the LIVESUN APP.	Install the LIVESUN APP.
		Check if the power switch (switch 1) is ON.	Turn on the power switch (switch 1).
		Use the APP in your phone to check with the history data.	Feedback the latest history data to the manufacturer for further analysis.