

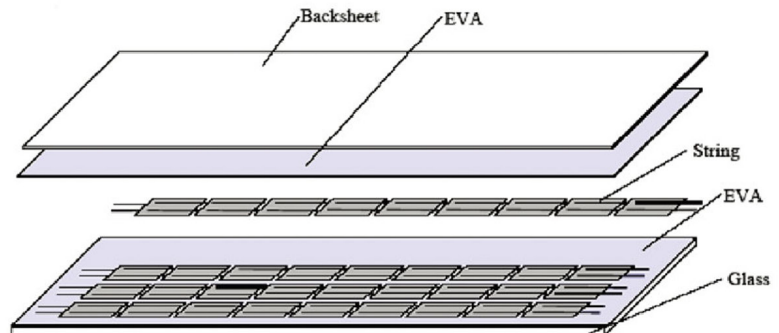

CHINALAND CHN-36P-150

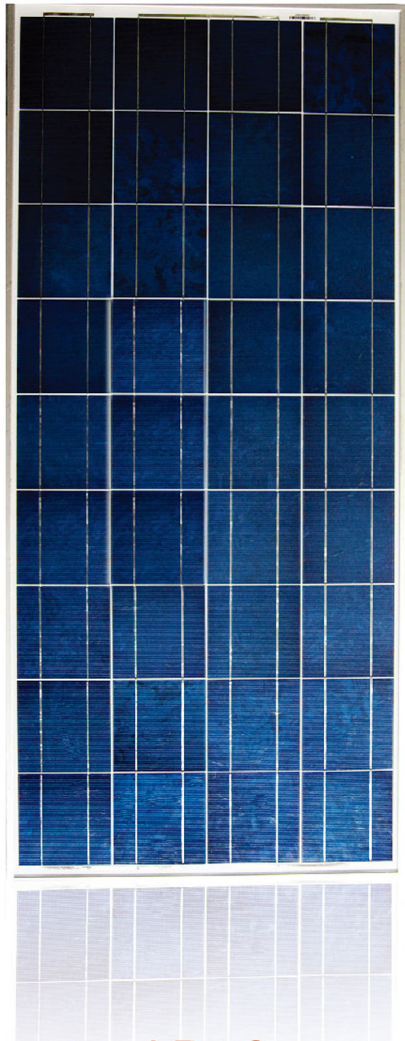

Power tolerance (0~+3%) to ensure the high reliability of power output



Modules certified by TUV to with stand high level of wind loads (2400 Pa) and snow loads(5400 Pa)



Special PV Module Insurances by world leading insurance company guarantees the benefit of PV investors and PV module users



Junction box and bypass diodes guarantee the modules free of overheating and "hot spot effect"

Guaranteed Performance**

10 Years Manufacturing Warranty

12 Years Warranty 90% Power Output

25 Years Warranty 80% Power Output

Free module recycling through membership in the Ceres Cycle Association

choosing chinaland solar

- The most vertically integrated solar manufacturer in the industry with production of ingots, wafer, solar cells and modules using both mono crystalline and multi crystalline technology.
- Global distribution with local warehousing, delivery and after sales services.
- Modules certified by global testing facilities: IEC61215, IEC61730, CE, ROHS.
- Manufacturing with international quality standards and environment management system: ISO9001 and ISO14001.
- Most updated design with drainage holes in the frame ensures the modules to withstand various weather conditions.
- Minimal wiring effort required as the module has high reverse current resistance.

CHINALAND CHN-36P-150

MECHANICAL DRAWINGS

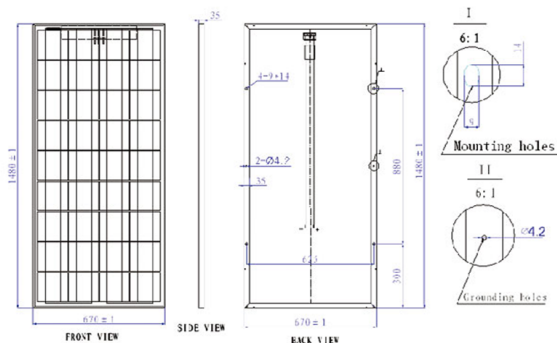

MECHANICAL SPECIFICATION

Cell Type	Poly Crystalline 156x156mm
Number of cells	36(4x9)
Dimensions (AxBxC)	1480x670x35mm
Weights	12kg
Front Glass	3.2mm tempered low iron glass
Frame	Clear anodized aluminium alloy
Junction Box	IP 65, with bypass diodes
Connector	MC4 compatible
Output Cables	TUV, ± length 900mm, 4.0mm²

ELECTRICAL CHARACTERISTICS

Maximum Power at STC(Pmax)	140W	145W	150W	155W
Short Circuit Current(Isc)	8.39A	8.51A	8.71A	8.89A
Open Circuit Voltage(Voc)	21.4V	21.6 V	21.8V	22.0V
Maximum Power Current(Imp)	7.83A	8.00A	8.17A	8.34A
Maximum Power Voltage(Vmpp)	17.9V	18.1V	18.4V	18.6V
Module Efficiency	14.12%	14.62%	15.13%	15.63%
Power Tolerance	0~+3%	0~+3%	0~+3%	0~+3%



STC: irradiance 1000W/m²



Module temperature 25 °C



AM=1.5

TEMPERATURE CHARACTERISTICS

Normal Operating Cell Temperature (NOCT)	45 °C ±2 °C
Temperature Coefficient of Pmax	-0.44% °C
Temperature Coefficient of Voc	-0.34% °C
Temperature Coefficient of Isc	0.06% °C

PACKING CONFIGURATION

Container	20'GP	40'GP
Pieces per pallet	30	30
Pallets per container	14	30
Pieces per container	490	1050

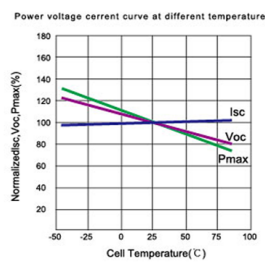
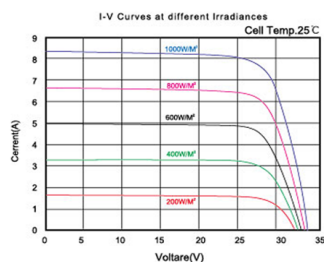

SYSTEM INTEGRATION PARAMETERS

Maximum system voltage	VDC 1000V
Maximum Series Fuse	15A
Increased snowload acc. to IEC 61215	5400Pa
Operating Temperature	-40to+85 °C
Number of bypass diodes	2 or 4

INDUSTRY-LEADING WARRANTY BASED ON NOMINAL POWER

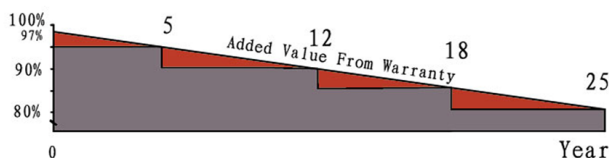

- Based on nominal power(pnom)
- 25-year transferrable power output warranty: 5 years/95%, 12 years/90%
18 years/85%, 25 years/80%
- 10-year material and workmanship

QUALIFICATIONS AND CERTIFICATES



FUTURE GREEN ENERGY PRIVATE LIMITED

Chamunda Marg, Nagpokhari, Naxal

+977 01-4434447

info@fge.com.np